

Rear Differential

| | | | |
|---|-----------|--|------------|
| 1) RUBBER MOUNT UPPER (2 req) | 133568 | 22) USED INNER AXLE SHAFT (2req) | 139531USEI |
| 2) RUBBER MOUNT LOWER (2 req) | 131796 | 23) OIL SEAL INNER (2 req) | 117952 |
| 3) MOUNTING WASHER (2req) | WM810 | 24) SCREW & WASHER (8req) | 123803 |
| 4) MOUNTING LOCK NUT (2req) | YN3209 | 25) INNER BEARING (2 req) | 533360A |
| 5) PINION FLANGE | UKC764 | 26) CIRCLIP (2 req) | 139532 |
| 6) PINION OIL SEAL | 141242 | 27) REAR MOUNT BUSHING (2 req) | 117578 |
| 7) PINION BEARING | 134070 | 29) GASKET | 114749 |
| 8) SHIM .010" | 140791 | 30) MOUNTING BOLT, WASHER & LOCK NUT | 136869 |
| 8) SHIM .005" | 140792 | 32) STUD NON ROTO (6 req MK1 4req MK3) | 131008 |
| 8) SHIM .003" | 140793 | 32) STUD ROTOFLEX (6 req) | 151824 |
| 9) PINION SPACER | 145933 | 33) WASHER | WP110 |
| 10) BOLT & SHAKE PROOF WASHER (4req) | 132856/SW | 34) LOCK NUT | YN2909 |
| 11) BOLT & LOCK WASHER (8req) | HU808/LW | 35) POLY DIFFERENTIAL FRONT MOUNT | IBAC11 |
| 12) SHIM .081" | 145922 | | |
| 12) SHIM .0885" | 145927 | | |
| 12) SHIM .0915" | 145929 | | |
| 12) SHIM .096" | 145932 | | |
| 13) REAR PINION BEARING | 134065 | | |
| 14) CROSS PIN | 134072 | | |
| 15) CROWN WHEEL & PINION 3.89:1 | 159801 | | |
| 15) CROWN WHEEL & PINION 3.63:1not orig fitted | 159802 | | |
| 15) CROWN WHEEL & PINION 3.27:1 (21H5478 carrier) | 159803 | | |
| 16) SHIM | 134075 | | |
| 17) GEAR 16 teeth | 134073 | | |
| 18) PINION GEAR 10 teeth | 134074 | | |
| 19) THRUST WASHER PINION | 148805 | | |
| 20) CARRIER BEARING 1966 - 73 KF20,000 (2 req) | 130355 | | |
| 20) CARRIER BEARING MK3 1973 from KF20001 (2 req) | GHB105 | | |
| 21) SHIM .003 | 156082 | | |
| 21) SHIM .005 | 156083 | | |

Rebuilt Differentials

Rebuilt Differentials come with a 12 month 12,000 mile warranty.

MK3 from KF20,001 (4 stud diffs)

REBUILT DIFFERENTIAL 3.89:1 (new ring & RTC2305N
(above diff comes with a NEW crown wheel & pinion set)
REBUILT DIFFERENTIAL 3.89:1 RTC2305R
REBUILT DIFFERENTIAL 3.63:1 (not original TKC3718R)

MK1, MK2 and MK3 GT6 up to KF20,000 (6 stud diffs)

REBUILT DIFFERENTIAL 3.89:1 515744N
(above diff comes with a NEW crown wheel & pinion set)
REBUILT DIFFERENTIAL 3.89:1 515744
REBUILT DIFFERENTIAL 3.27:1 515743

\$200.00 core charge on rebuilt Differentials.

USE ONLY GL4 OIL in Differentials!!

Drive Shafts

| | |
|-----------------------------------|-----------|
| 1) DRIVE FLANGE (2req) | 37H4973 |
| 2) BOLT & LOCK NUT (8req) | 132023/LN |
| 3) U JOINT (2req) | HS150 |
| 4) DRIVESHAFT OVERDRIVE 36" | 213151 |
| 4) DRIVESHAFT NON OVERDRIVE 39.5" | 213150 |

Differential

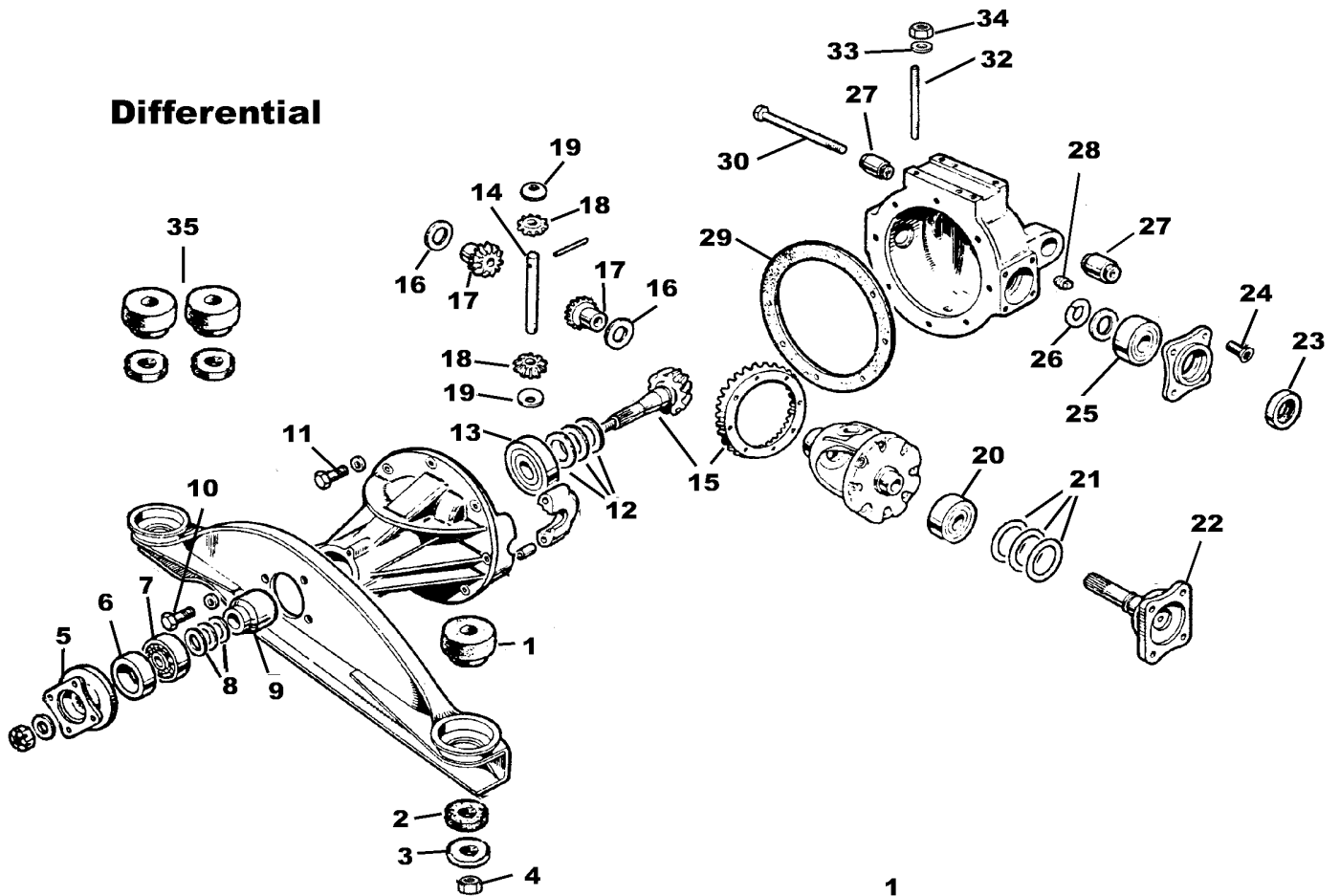

Drive Shaft

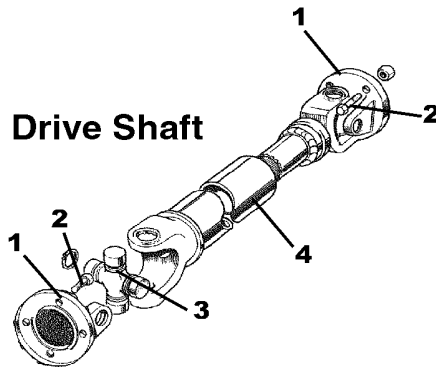

Rebuilt Differential

