

## Rear Suspension MK2 & MK3 up to KF20,000

1) DRIVE FLANGE BOLT & LOCK NUT (16req)	132023/LN
2) DRIVE FLANGE (2req)	37H4973
3) U JOINT (2req)	HS150
3) U JOINT (2req) "hardy spicer"	GUJ101
4) DRIVESHAFT INNER (2req)	214623
5) WOODRUFF KEY (2req)	104581
6) SPRING THRUST BUTTON (8req)	114006
7) BUMP STOP (2req)	150583
8) ROTOFLEX BOLT LONG (6req)	144588
8) ROTOFLEX BOLT SHORT (6req)	141850
9) INNER WHEEL BEARING SEAL (2req)	GHS125
10) WHEEL BEARING KIT (2req)	GHK1528
11) AXLE SHAFT LOCK NUT (2req)	510618
12) WASHER (2req)	142333
13) HUB ASSEMBLY USED (2req)	149051/USED
14) WHEEL STUD (16req)	158729
15) BEARING SHIM .143	152485
15) BEARING SHIM .148	152486
16) OUTER WHEEL BEARING SEAL (2req)	GHS130
17) VERTICAL LINK RH USED	308437USED
17) VERTICAL LINK LH USED	308438USED
18) BOLT WASHER & LOCK NUT (2req)	SHDW7
19) SPRING BUSH (2req)	C8939
20) LEAF SPRING	308499
21) KYB GAS SHOCK ABSORBER (2req)	GSA280
21) SPAX SHOCK ABSORBER (2req)	G464
21) GAZ SHOCK ABSORBER	GT4-2273
22) POLYURETHANE REAR WISHBONE BUSH KIT	BAC18
23) RADIUS BRACKET RH	148975
23) RADIUS BRACKET LH	148976
24) BOLT, WASHERS & LOCKNUT (2 req)	SHDW9
25) POLYURETHANE SHOCK BUSH KIT	BAC19
26) COMPLETE TRUNNION KIT shown below (1req)	148940KIT

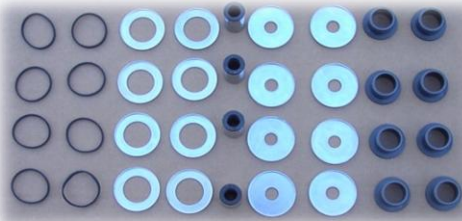

30) RADIUS ARM ASSEMBLY (2 req)	151092
31) BOLT, WASHER & LOCK NUT (4 req)	SHDW2
32) PIVOT BRACKET (2 req)	148963
33) RADIUS ARM BUSH (4 req)	119450
34) JAM NUT RH THREAD (2 req)	128022
34) JAM NUT LH THREAD (2 req)	151110
35) ADJUSTER WITH NUTS (2 req)	151099
36) POLYURETHANE RADIUS ARM BUSH KIT	BAC17
37) BOLT & LOCK /NUT (2 req)	SHDW8
38) WISHBONE INNER BUSH (2 req)	548208
39) ROTOFLEX COUPLING (2req)	QL8000

## Rear Suspension MK1 & MK3 from KF20,001

1) REAR STD SHOCK ABSORBER (2req)	GSA385
1) SPAX ADJUSTABLE SHOCK (2req)	G211
1) GAZ SHOCK ABSORBER	GT4-2270
2) LOCK NUT (2req)	YN2910
3) THICK WASHER (2req)	WM69
4) VERTICAL LINK RH NEW	132763
4) VERTICAL LINK RH RECONDITIONED	132763REC
4) VERTICAL LINK LH NEW	132764
4) VERTICAL LINK LH RECONDITIONED	132764REC
5) BOLT WASHER & LOCK NUT (4req)	SHDW4
6) RADIUS ARM BUSH SMALL (2req)	119451
6) RADIUS ARM BUSH LARGE (2req)	146321
7) RADIUS ARM BRACKET LH	159840
7) RADIUS ARM BRACKET RH	159841
8) RADIUS ARM ADJUSTING SHIM	133070
9) LOCK NUT & WASHER WP9 (4req)	YN2909/W
10) BOLT WASHER & LOCK NUT (4req)	SHDW5
11) BOLT WASHER & LOCK NUT (2req)	SHDW6
12) SHOCK BUSH (8req)	102987
12) POLYURETHANE SHOCK KIT (1req)	BAC19
13) BOLT (8req)	HU807
14) DRIVE FLANGE WITH STUDS (2req)	131567
15) WHEEL STUD (16req)	158729
16) INNER HUB TAB WASHER (4req)	121860
17) GREASE SHIELD (2req)	104582
18) HOUSING OIL SEAL (2req)	104773
19) HUB USED (2req)	204226USEI
20) REAR TRUNNION KIT (2 req)	QSK151
21) AXLE SHAFT LOCK NUT	510618
22) WASHER (2req) not included with #26	142333
23) OUTER HUB SEAL (2req)	GHS111
24) GASKET (2req)	GFG117
25) INNER HUB SEAL (2req)	128978
26) WHEEL BEARING KIT (2req) #22 not incl	GHK1029
27) GREASE FITTING (2req)	56935
28) OIL FLINGER (2req)	128469
29) WOODRUFF KEY	104581
30) HALF SHAFT MK3 (2req)	155928
30) HALF SHAFT MK1 (2req)	129003
31) U JOINT (2req)	HS150
31) U JOINT hardy spicer (2req)	GUJ101
32) BOLT & LOCK NUT (8req)	132023/LN
33) DRIVE FLANGE (2req)	37H4973
34) SPACER, BOLT, WASHER & NUT MK3	149190KIT
35) SPRING PIVOT BOX MK3 after KF20001	159641
36) PIVOT BOX SPRING PAD MK3 KF2000	149191
37) LEAF SPRING MK1	307324
37) LEAF SPRING MK3 after KF20000	159640
38) SPRING THRUST BUTTON (8req)	114006
39) SPRING BUSH (2req)	C8939

**MK1 & MK3  
after KF20001**

**MK2 & MK3  
up to  
KF20000**

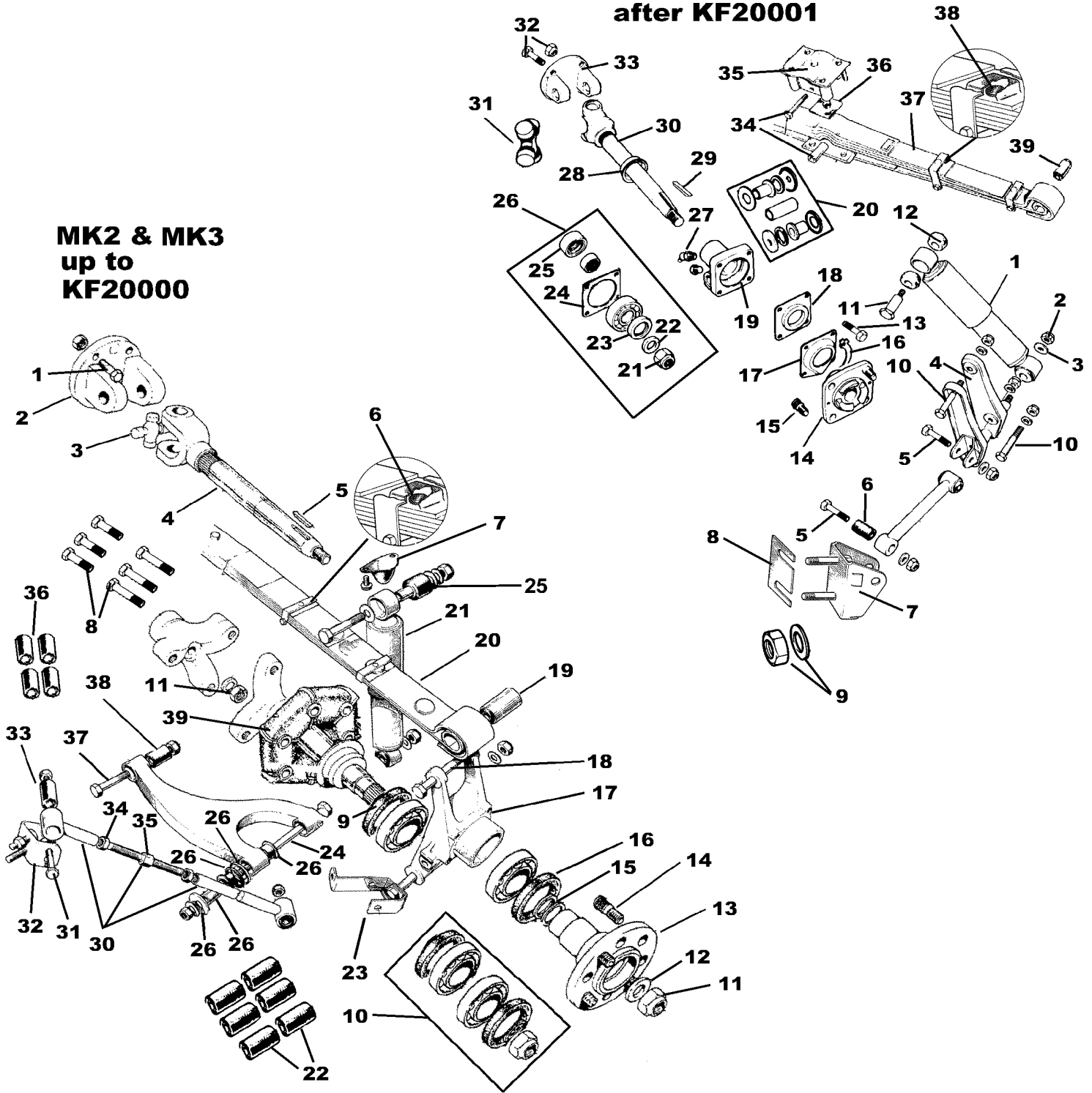

## Front Suspension

1) UPPER A ARM (4req)	119272
2) UPPER BALL JOINT (2req)	GSJ155
3) BOLT WASHER AND LOCK NUT (4req)	SHDW3
4) WISHBONE BUSH (8req)	119451
4) WISHBONE BUSH SET POLY	BAC12
5) LOCK NUT & WASHER (6req)	YN2907/W
6) SPRING TOP PLATE (2req)	122137
7) COIL SPRING STANDARD 200LBS (2req)	212425
7) COIL SPRING UPRATED 25% 1" LOWER (2req)	212425U
8) FRONT SHOCK ABSORBER (2req)	GSA267
8) SPAX SHOCK ABSORBER (2req)	G210-S
8) GAZ SHOCK ABSORBER	GSO2269
8) GAZ SHOCK ABSORBER adjustable seat	GP4-2271
9) LOWER A ARM RH	206685
9) LOWER A ARM LH	206686
10) BOLT WASHER AND LOCK NUT (4req)	SHDW2
11) MINOR TRUNNION KIT (2req)	QSK140S
12) TRUNNION LH OE	140920
12) TRUNNION RH OE	140919
13) TRUNNION SEAL (2req)	122126
14) LOWER BUSH SHOCK (2req)	119450
15) WHEEL BEARING GREASE CAP (2req)	132665
16) CASTLE NUT (2req)	LN2211
17) SPLIT PIN (2req)	PC020
18) WASHER (2req)	102690
19) WHEEL BEARING KIT (2req)	GHK1011
20) WHEEL STUD (16 req)	158729
21) STUB AXLE (2req)	132065
22) HUB SEAL (2req)	GHS146
23) ALUMINUM FRONT HUB (2req)	145007A
24) VERTICAL LINK LH	GSJ264
24) VERTICAL LINK RH	GSJ267
25) TIE ROD LEVER RH	205504
25) TIE ROD LEVER LH	205505
26) OIL NIPPLE VERTICAL LINK (2req)	LN30041
27) LOCK NUT (2req)	YN2912
28) BOLT & WASHER TOP (4req)	HU806/LW
28) BOLT SHORT BOTTOM REAR (2req)	HB910
28) BOLT AND LOCK NUT BOTTOM FRONT (2req)	HB918/LN
29) SEAL (2req)	138051
30) LOCKNUT & THICK WASHER WP9 (4req)	YN2909/TW
31) BOLT AND LOCK NUT (8req)	SHDW1
32) SHIM	122022
33) FRONT PIVOT BRACKET (2req)	130757
34) REAR PIVOT BRACKET (2req)	130758
35) UPPER BUSH SHOCK (4req)	122324A

## Front Suspension Kits & Shock Kits

FRONT SUSPENSION KIT with rubber bushe QSK88  
*Above kits includes: ball joints (2), wishbone bush (8), lower shock bush (2), trunnion (2), trunnion seal (2), trunnion kit (2), bolts & locknuts (16).*



FRONT SUSPENSION KIT (Poly Bushes) QSK88POLY  
*Above kits includes: ball joints (2), poly wishbone bush (8), trunnion (2), trunnion seal (2), trunnion kit (2), bolts & locknuts (16).*

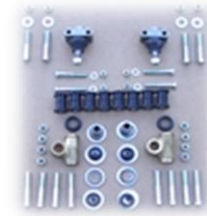

SPAX SHOCK KIT SBK52  
*Above kit includes 2 X G210 & 2 X G211 shocks.*

STANDARD SHOCK KIT SBK53  
*Above kit includes 2 front and 2 rear shocks.*

## Anti Sway Bar

1) LOCK NUT (2req)	YN2909
2) WASHER (2req)	WP110
3) STUD (2req)	125074
4) RIGHT HAND LINK	125481
4) LEFT HAND LINK	125482
5) ANTI SWAY BAR 7/8" MK3 from KF20001	217033
6) MOUNTING RUBBER 1966-1973 KF2000(	123998
6) MOUNTING RUBBER MK3 1973 KF20,00	155310
6) SWAY BAR KIT (POLY) 1966-73 KF2000(	BAC13/A
6) SWAY BAR KIT (POLY) MK3 from KF20,0	BAC13
7) SADDLE CLAMP 1966-73 up to KF20000 (	123502
7) SADDLE CLAMP from 1973 KF20,001 (2r	155308
8) U BOLT 1966-1973 KF20,000 (2req)	123694
8) U BOLT MK3 from KF20,001 on (2req)	155307
9) LOCK NUT & WASHER (4req)	YN2908/W

# Front Suspension

# Anti Sway Bar

